

# FlexWATCH 1160S and 1160SE – Network Camera Server Pan/Tilt/Zoom

## Network Camera Server Pan/Tilt/Zoom

FlexWatch 1160S/SE is a stand-alone PTZ network camera which has built-in PAN/TILT/ZOOM camera, Web Server and Real time operation system. With powerful PTZ feature, you can remotely move camera to any direction or zoom in/out the object from anywhere through standard web browser.

It delivers real time live videos at a rate up to 30fps over the TCP/IP network.

Fast Pan/Tilt, superb 270x zoom (27x optical, 10x digital zoom) and up to 32 presets function enable you to easily focus camera to the target location and zoom up the object with simple mouse click.

Day&Night camera function, IR sensitivity, WDR (Wide Dynamic Range) for clear image view under back light situation and DSS (Digital Slow Shutter) to view object under low light condition are specific of the camera performance.

Built-in motion detection, up to 5M pre/post alarm buffer, RS-232/RS-485 interface for serial input device, X10 device and advanced alarm notification interface for e-mail, FTP and third party program are some of key features of FlexWatch 1160S.



### **VideoWave Networks Inc.**

7493 Transcanadienne, suite 103

Ville St-Laurent (Québec) H4T 1T3 Canada

info@videowave.ca www.videowave.ca ☎ (514) 668-1845 Fax (514) 789-0878

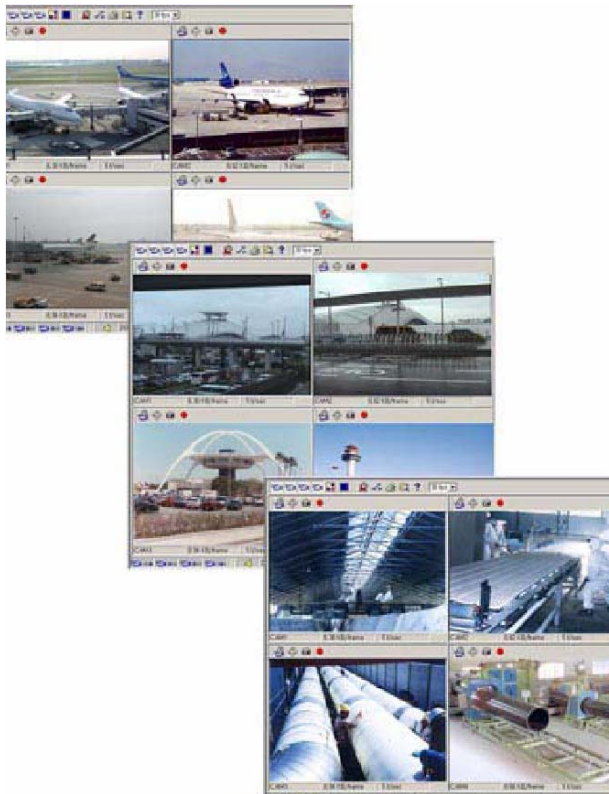

## Key Features

- **High performance of video transmission**  
30 fps(NTSC) / 25 fps(PAL) at CIF video format over the TCP/IP network.
- **Superb zoom and camera performance**  
Up to 270x ZOOM (27x optical, 10x digital) and Day&Night, WDR and DSS function.
- **High speed Pan/Tilt with 16 presets**  
PAN-360°/sec, TILT-200°/sec on Preset mode and continuous camera rotation without limit.
- **Vandal Proof and External housing**  
Protect camera with Vandal and Weather proof housing (IP66) with heat&blower for external or any tough environment (**FW-1160SE-only**).
- **5M Pre/Post video alarm buffer**  
5M extra memory for pre/post alarm buffer to store event triggered video in the internal memory.
- **Advanced alarm notification and service**  
Powerful FTP, e-mail and Alarm notification to CGI path to third party Web server by various alarm condition.

## Technical Specifications

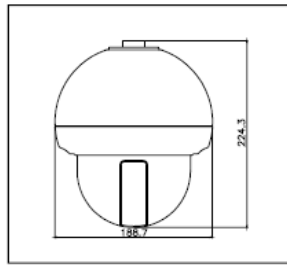

**Dimension :mm**



**FW-1160S**

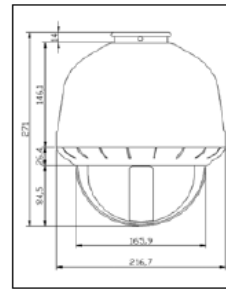

**Dimension :mm**



**FW-1160SE**

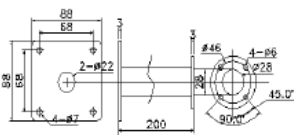

**FSD-230CB**

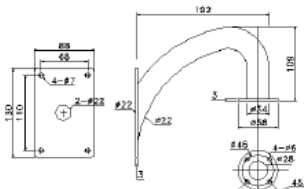

**FSD-230WB**

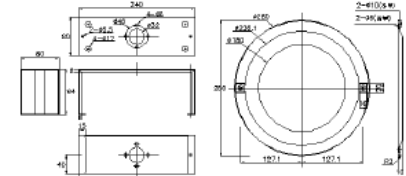

**FSD-230ICB**

## VideoWave Networks Inc.

7493 Transcanadienne, suite 103  
Ville St-Laurent (Québec) H4T 1T3 Canada

info@videowave.ca www.videowave.ca (514) 668-1845 Fax (514) 789-0878

**Hardware**

- 32bit Embedded CPU
- Flash 4MB / SDRAM : 64MB
- Hardware Motion JPEG engine
- Linux version 2.4.xx operating system

**System Requirements**

- OS : Win95/98/2000/XP/NT/ME, Linux, MAC, Unix.
- Browser : MS Internet Explorer (5.x or above), Netscape (6.x or above).
- PC H/W Pentium III 500 MHz or above.
- RAM : 64 MB and above

**Network Protocols**

- HTTP, TCP/IP, FTP, Telnet, RARP, PPP, PAP, CHAP, DHCP, SMTP client (e mail), NTP, PPPoE, Java.

**Video**

- NTSC : 704x480, 704x240, 352x240, 176x112
- PAL : 704x576, 704x288, 352x288, 176x144
- Frame Rate : 30 fps (NTSC) / 25 fps (PAL)
- Image quality : 6 levels

**Camera**

- Image Sensor : 1/4" Sony CCD
- Resolution : 480 TV Lines
- Sensitivity : 1.0 200,00 Lux (F/1.5)  
Day&Night mode : 0.1 Lux  
DSS (Digital Slow Shutter) : 0.01 Lux
- Lens : 27x optical zoom, F/1.5 (Wide)  
3.8 (Tele), f=3.25-88.0 mm, 10x digital zoom

**Pan/Tilt**

- Max Speed : PAN-360 °/sec, Tilt-260°/sec
- Rotation angle : H : 360° / V : 90°

**Serial Interface**

- 2 serial ports for console, modem, serial input/output device or Voice kit.

**LAN interface**

- 10/100 BaseT Ethernet auto sensing

**Alarm I/O interface**

- 1 opto-coupled inputs or 1 Relay output.

**Advanced Service**

- Up to 5M memory for Pre/Post alarm buffer.
- Built-in motion detections (up to 144 blocks).
- E-mail, FTP, alarm buffer by event or schedule.
- IP notification, Alarm notification to e-mail, CGI path by event or schedule.

**Others**

- Time stamp on Video.
- Transmit serial input data transfer with video.
- IP notification by e-mail.

**Configuration**

- Configurable by serial or web.
- Remote system update via FTP or web.

**Developer Support**

- Provides http CGI API
- ActiveX control development kit

**Approval**

- FCC : Classe A / CE : Classe A

**Dimensions**

- FW1160S : 224.3 mm(8.83")x188(7.40 ")
- Weight : 3 kg (6.6 lbs)
- FW1160SE : 271.3 mm(10.66")x216(8.5")
- Weight : 5.9 kg (12.9 lbs)

**PWR Supply**

- 24V AC, 1.5amp

**Operating Environment**

- Temperature : 40° ~ 125° F (5° ~ 50° C)
- Humidity : 20 ~ 80%

**Accessoires**

- Console cable for system setup
- CD for user guide, Installation Wizard
- Quick installation guide.

**Miscellaneous**

- Voice kit (FW-V10s) support.
- Work with FW-Manager NDVR S/W
- Dynamic IP support through AOIP.

**Mounting Support**

- FSD-ICB : In-Ceiling bracket
- FSD- WB : Wall mount bracket
- FSD-CB : Ceiling pendent bracket

(FSD-WB is Basically offered with FW-1160SE. For the FW1160S, any one of these brackets needs to be separately purchased.)

**VideoWave Networks Inc.**

7493 Transcanadienne, suite 103  
Ville St-Laurent (Québec) H4T 1T3 Canada

info@videowave.ca www.videowave.ca ☎ (514) 668-1845 Fax (514) 789-0878